

President's Message  
Gregory J. Harber

Slowly, the first signs of spring are creeping across the landscape. Trees and bushes, bare and gray after a seemingly protracted winter, are showing the faintest hint of green as leaves and buds emerge from their winter dormancy. The cardinals and wrens are in full-throated song these days. So much so, in fact, that on a bright sunny day it's hard to tell who is more elated about the impending explosion of spring – the birds or me!

Yesterday (March 13th) I had the pleasure of strolling the trails at Lanark, the home of the Alabama Wildlife Federation near Millbrook, AL. The day was somewhat chilly and dreary; light sprinkles and gray skies reminded us that March is often prone to bouts of winter. For the most part we encountered the birds typical of any Alabama woodland setting: several species of woodpeckers, Wood Ducks, bluebirds a'courtin in the meadow, sparrows fushing from under the brush and wrens, chickadees and titmice ducking here and there.

Amongst all these common birds were two Blue-headed Vireos. To my eyes, their soft, clean colors and seamless markings paint a picture of subtle beauty that is so often under-appreciated. I enjoyed watching the vireos as they steadily selected their way through the canopy while the other birds tussled in the leaves below.

The antithesis to the vireo, in almost every way, was a Blue-gray Gnatcatcher. This Plain Jane of a bird looked like a hyperkinetic ball of energy tumbling over and around each branch in search of a morsel, all the while whipping its tail this way and that! In summer, the gnatcatcher is as common as dirt in a country house, but on this day – amidst this last gasp of winter – the plain little bird in the nearly non-existent foliage was a most elegant harbinger of spring. Lordy, the sight of that bird made my heart leap as surely as the father's prodigal son returning home at long last!

Reports from the coast of neotropical migrants are starting to appear on the AL-birds and FL-birds lists. Purple Martins and Swallow-tailed Kites (yes!) were among the first to appear. Behind them will surely follow a legion of other migrants from across the far waters. Indeed, Northern Parulas and Louisiana Waterthrushes are now arriving too, fulfilling the promise of spring. I hope that the birders posting these reports realize that they serve as a bit of a mental lifeline on which we inland-bound birders cling, biding our time until we can indulge our passion too.

I hope you'll be able to visit Dauphin Island this spring, and enjoy the fruits of our land conservation efforts these past few months. John Porter, our volunteer Executive Director, recently closed on the four lots on the south side of the Shell Mounds Park. This acquisition was made possible by the generosity of John Stowers, John and Beverly Winn, and a host of DIBS friends and supporters. Read John's report on page 2 for further details.

John also closed the deal on two wet lots on the eastern end of the island, near the intersections of Admiral Semmes Ave with Dewberry and Epinet Str. This location is not likely on your list of places you've visited on the island, but once you've birded the site and observed the flooded habitat, you'll want to make this a regular stop. As you travel east on Bienville Blvd, turn right onto Forney Johnson, then take the second left onto Admiral Semmes.

Last but not least, you'll want to visit the Goat Trees Reserve at the intersection of Grant Street and Cadillac Avenue. Saturday, March 20th members of the Coastal Birding Association and DIBS volunteers held a work day and cleared the underbrush from the trails and low hanging foliage near the water drip, in an effort to make the area surrounding the drip more attractive to the birds. Rest a spell at any of several benches in the reserve and enjoy the peace and solitude – and the birds, of course!

### America's Birdiest City/County Bird-a-thon

As has become customary we will be hosting America's Birdiest City/County bird-a-thon this year, thanks to Mike Wilson's continuing dedication to the cause. See page 3 for details!

### Land Acquisition

#### Shell Mounds Park - DCNR - Marine Resources

We closed on the purchase of the lots at the entrance to the Shell Mounds, shown on the plat below, on March, 10, 2010. This completed the protection of this critical piece of stop-over habitat, an effort begun ten years ago with our first property purchases, just west of the Bee Tree, also shown on the plat.

Early on it was generally assumed that this property was an integral part of the park. However, in fact, the four lots on the corner of Iberville and Cadillac were the site of the original Dauphin Island School and owned by a foundation. Surprisingly, in mid April 2007, we learned that the property had been deeded to the University of South Alabama Foundation with a covenant requiring the proceeds from its sale to be used for scholarships. To this end it was put up for sale by competitive bid. Closing date for bids was May 1, 2007! John Stowers (Sto), jumped into the fray immediately and offered to finance the purchase, subject to a promissory note from DIBS to repay the purchase price within ten years. Working together, we quickly got an appraisal for the property, \$200,000. Sto then submitted a bid for \$200,100 on the off chance that another prospective buyer might get the same appraisal. Fortunately, our bid was high! We then entered into a lease purchase agreement with Sto to secure payment within ten years and manage the property in the interim.

After several fruitless years of exploring funding sources to pay off this debt we were rescued by a long standing benefactor, John Winn. In the fall of 2009 he established a challenge grant fund for \$100,000 at the Community Foundation of South Alabama, in memory of his recently deceased wife Beverly. We then pledged to match his generous grant with the balance required to pay off the obligation to Sto. During the fall of 2009 we formally solicited donations to the Community Foundation to help us match the need, setting the closing date for the campaign for the end of the year. But when that time arrived the Foundation was still receiving donations so we extended it to the end of January. By then we had generated an additional \$30,000 as match. With the generous support of many individuals as well as that of the Birmingham Audubon Society and the Alabama Ornithological Society we were able to complete the match and finally complete the acquisition.

You should know, however, that we left some funds in the corpus of the fund with the Foundation so that future donations could be matched.

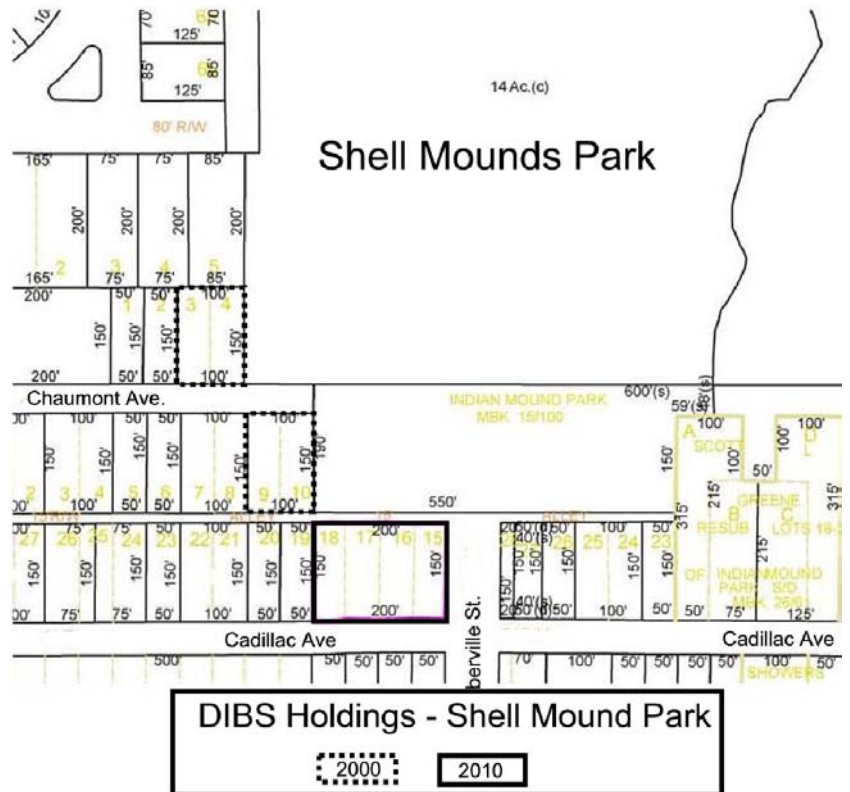



## BEVERLY WINN FUND FOR THE BIRDS

The Dauphin Island Bird Sanctuaries, Inc. would like to thank the following individuals, organizations, and companies for their financial support of our conservation efforts by their generous donations to the Beverly Winn Fund for the Birds. As detailed in John's report, your faithful support has enabled us to acquire the four lots immediately south of Shell Mounds Park, thereby ensuring that even more quality stopover habitat is forever preserved for the birds. If we have omitted your name from this list, please contact our treasurer, Mary Porter, at 251/861-2120 or maryfintporter@gmail.com.

Bianca J. Allen	Dr. R. M. McPhearson, Jr.
Gussie Arnett	Mr. Thomas R. McPherron
Jeanne Azen	Dr. Frank L. McPhillips
Mrs. Russell Bailey	David W. Mehlman
Emery E. Baya	Sandra L. Miller
Lela Anne Brewer	Edwina C. Mullins
Dr. Ernest P. Brody	Steven O'Sheal
Loretta G. Brown	Ethel N. Owen
Mr. & Mrs. Paul H. Burkholder, Jr.	Linda A. Percival
Robert Burns	Paul & Dianna Porter & Family
Jinksie & Denson Burnum	Mary & John Porter
Mr. & Mrs. Marion C. Bush	Frank Reid
Angela L. Byrd	Elberta G. Reid
Eugenia P. Carey	Dick & Linda Reynolds
Mr. & Mrs. Tom Carruthers	Merilu C. Rose
David M. Clothier	Mr. & Mrs. Philip T. Sankey
Joy W. Cook	Sheilia L. Shaw
Dr. & Mrs. W. Frank Cope	Frances B. Shepherd
Bill & Nancy Cox	James W. Shepherd
Elsie K. Croft	Floyd Sherrod
Mr. & Mrs. Thomas P. Czepiel	Mr. & Mrs. Charles M. Shirk
Temd & Lucy Deason	Joan & Tom Siegwald
Mr. & Mrs. Lamont H. Dees	Maud Skiba
Bob & Lucy Duncan	Mary France Stayton
Brad & Donna Dye	A. J. Stringer
James L. Early	Rosalind B. Swart
Shirley & Frank Farrell	Bob & Ann Tate
Peter S. Finlay	Muriel E. Tetlow
R. Lynne Fitzgerald	Mr. & Mrs. John E. Toomey III
Venetia B. Friend	Judge and Mrs. Scott Vowell
Dr. and Mrs. James W. Green	Greg, Patti, Beth & Anna Waldrip (Honorarium for John & Mary Porter)
Ron & Darlene Hansen	Jon & Beth Waldrip (Honorarium for Bill, Laura, Lisa, Greg, Patti, Beth & Anna Waldrip)
Gregory J. Harber	George D. Walker
John Tullo & Lucy Harber	Larry F. Warren
Terry P. Harris	Shirley A. Wayland
Cathy & Ralph Havard	Julia A. Willis
Lida I. Hill	John Winn
Dr. Diane C. Holliman	Elizabeth M. Wolfe
Richard V. Horan	Larry F. Wright
A. J. Isacks III	Harriett H. Wright
Kathryn Keaton	
Joan M. King	
Michael Krumpelt	
Patsy K. Larsen	
Ann M. McLaurin	
	Alabama Ornithological Society
	Mitchell, McLeod, Pugh & Williams, Inc.

The Dauphin Island Bird Sanctuaries, Inc. would like to thank the following individuals, organizations, and companies for their financial support of our conservation efforts by becoming members, renewing their memberships, or making special, honorariums, and memorial gifts. This list represents contributions received between August 31, 2009 and March 15, 2010. If we have omitted your name from this list, please contact our treasurer, Mary Porter, at 251/861-2120 or maryfintporter@gmail.com.

**Special Gifts**

Butch & Connie Baggett  
 Gayle & Sandy Barnett  
 Robert L. Sims & Katherine A. Bouma  
 Carey & Lynne Cooper  
 Angela & Robert Dixon  
 David & Carrie Dortch  
 Donna & McCune Dudley  
 Gregory J. Harber  
 Catherine Crothers Hodges  
 Paul Kittle  
 Laurie Oswald & Hans Paul  
 Charlie Burlee & Betsy Rogers  
 A. J. Stringer  
 Ann & Bob Tate  
 Kenneth & Rufna Ward  
 ExxonMobile (Matched Gift from Sam A. Flint)  
 Gulf Coast Bird Observatory  
 The Nature Conservancy

From: Ann Miller

**For: John F. Porter, Jr**  
 From: Gayle & Sandy Barnett (Happy Birthday)  
 The Greg Waldrip Family (Happy Birthday)

**For: Edith Tolson Upchurch (Edith Hunt's Mother)**

From: Bianca J. Allen  
 Jeanette & Jimmie Hancock  
 Pelham Rowan  
 Mary Frances Stayton

**Memorials:**

**For: Zoe Neville Kearns**  
 From: Hillary L. Cabaniss  
 J. R. Delaney & William R. Delaney  
 W. B. Erickson, Jr.  
 Janet & Daniel Farmer  
 Harold Stuart Kearns, Jr.  
 Uyang Wan Kearns  
 Ginger McKinney  
 Elizabeth Ktitrell  
 Brett & Anne Pechuls  
 Erin Wheeler

**For: Thelma C. Wallace (Pat Reed's Mother)**

From: Mary Frances Stayton

**For: Beverly Hendricks Winn**

From: Elberta G. Reid  
 Roger Saatzer  
 Mary Wesley

**Honorariums:**

**For: Blanche Emerson**  
 From: Donna & McCune Dudley

**For: Gregory J Harber**  
 From: Aldridge Botanical Gardens  
 Friends of Emmet O'Neal Library

**For: Ava Ila Dean (Harry Dean's Mother)**

From: Linda & Dick Reynolds

**For: Chazz Hesselein**  
 From: Pete and Dona Townsend

**For: Mary Dowdell Ashley (Bonnie Harris)**

From: Lela Anne Brewer  
 Mary Lou Miller

**For: Wimberly Hory**  
 From: Donna & McCune Dudley

**For: Dr. Dan Clark Holliman**

From: Mary Lou Miller

**For: Bennett Moison (Grandson of Harry & Pam Dean)**  
 From: Linda and Dick Reynolds

**For: Dolly Little (Howard Horn's Grandmother)**

From: Joan & Tom Siegwald

**For: Bill & Ellen Kimrey  
 John & Dawn Lester  
 Alan & Shelia Miller  
 Maureen Miller  
 Roger Miller  
 John & Leigh Ann Siddle**

**For: Renee Dorothy McDonald**

From: Mary Lou Miller  
 Fay Chazin Seidelman

**Fall 2009 AOS Contributors**

Jinksie & Denson Burnum  
 Bobby Cheronos  
 Alice Christenson  
 Will & Deborah Coggins  
 Charlotte Fanz  
 Charles Hesselein  
 Sandra F. Kendall  
 Ranny & Cheryl Kittinger  
 Cynthia Lewis  
 Curtis & Gladys Miyasaka  
 Elberta G. Reid  
 Tom & Joan Siegwald  
 Ann & Donald Sweeney  
 Harriett H. Wright

**Winter 2010 AOS Contributors**

Martha Dagg  
 Charles & Susan Hutchison  
 Ranny & Cheryl Kittinger  
 Bill McAllister  
 Glenda McNair  
 Elberta G. Reid  
 Maureen Shaffer  
 Tom & Joan Siegwald  
 James & Shirley Wayland  
 (continued on back page)

~ Membership or Renewal Application ~  
 Dauphin Island Bird Sanctuaries, Inc.

Name: \_\_\_\_\_  
 Address: \_\_\_\_\_  
 City: \_\_\_\_\_ State: \_\_\_\_\_ Zip: \_\_\_\_\_  
 Phone: (\_\_\_\_) \_\_\_\_\_  
 E-mail: \_\_\_\_\_

Membership Levels:  
 Northern Cardinal, \$25  
 Indigo Bunting \$50  
 Rose-breasted Grosbeak, \$100  
 Snowy Egret, \$250

Great Egret, \$500  
 Life Member, \$1,000  
 Family Life Member, \$1,250  
 My check for \$\_\_\_\_\_ is enclosed.

Please make check payable to: DIBS, Inc.  
 Mail this form and check to:  
 Mary F. Porter, DIBS Treasurer  
 P.O. Box 1295  
 Dauphin Island, AL 36528-1295



Dauphin Island Bird Sanctuaries, Inc.  
P. O. Box 1295  
Dauphin Island, Alabama 36528  
251.861.2120/phone  
251.861.2204/fax  
dibird@centurytel.net

Non-Profit Org.  
U. S. Postage  
PAID  
Permit No. 361  
Birmingham, AL

ADDRESS SERVICE REQUESTED

A non-profit organization dedicated to the preservation of the Dauphin Island Audubon Sanctuary and other ecologically valuable habitat on Dauphin Island

**PLEASE CHECK YOUR MAILING LABEL FOR YOUR MEMBERSHIP EXPIRATION DATE**

**New and Renewed Members for August 1, 2009 through March 15, 2010**

**New Life Member:**

George M. Shola

Temd & Lucy Deason

Blanche S. Emerson

Linda L. Fagan

Paul & Ann Burkholder, Jr.

Bill & Nancy Cox

Bobby Doris Cheronos

**Rose-breasted Grosbeak Level**

**New Members:**

Bruce & Doretha Holbert

Peter & Therese Finlay

John Tullo & Lucy Harber

Anne F. Heard

Elsie K. Croft

Lucy & Bob Duncan

Darlene & Ron Hansen

**Renewed Members:**

Loretta G. Brown

John L. Hinton, Sr.

Michael Jordan

Gregory J. Harber

Celeste Hinds

Patsy & James Causey

William & Cindy McFadden

Robert & Pat Meaher

Tom & Lynn Howes

Nathan & Margaret Miller

Amy & Irvin Christian

Linda & David Miller

Jay & Lisa Murray

Roy & Barbara Price

Vidmantas & Maria Raisys

Lida Hill

Cathy O'Sheal

Rufus & Merilu Rose

Edwina & James Robertson

Tom & Martha Rogers

Larry F. Warren

Allen & Marilyn Sullivan

Frances M. Young

Coralie & John Toomey

Susanne Wadsworth

Amanda & Nathaniel Winstead

**Indigo Bunting Level**

**New Members:**

Dale & Tom Carruthers

Joan Rommes

**Northern Cardinal Level**

**Renewed Members:**

Lester & Dorothy Burroughs

Ray & Joyce Bonilla

John & Mitzi Wolf

Remember to join us the weekend of April 15-18, 2010 (AOS) as we attempt to defend our title as America's Birdiest Small Coastal City! Teams of up to four people will have 72 hours (noon Thursday through noon Sunday) to identify as many species as possible on Dauphin Island & the adjacent Pelican Island. Birds must be seen from dry land. Prizes will be awarded! For full details please visit <http://coastalbirding.org/>